



The following guide illustrates how to connect your PrintAPI to your WooCommerce Plugin in 8 steps:

1. Create an account on [PrintAPI.nl](https://printapi.nl).



2. Select the option: REST API.

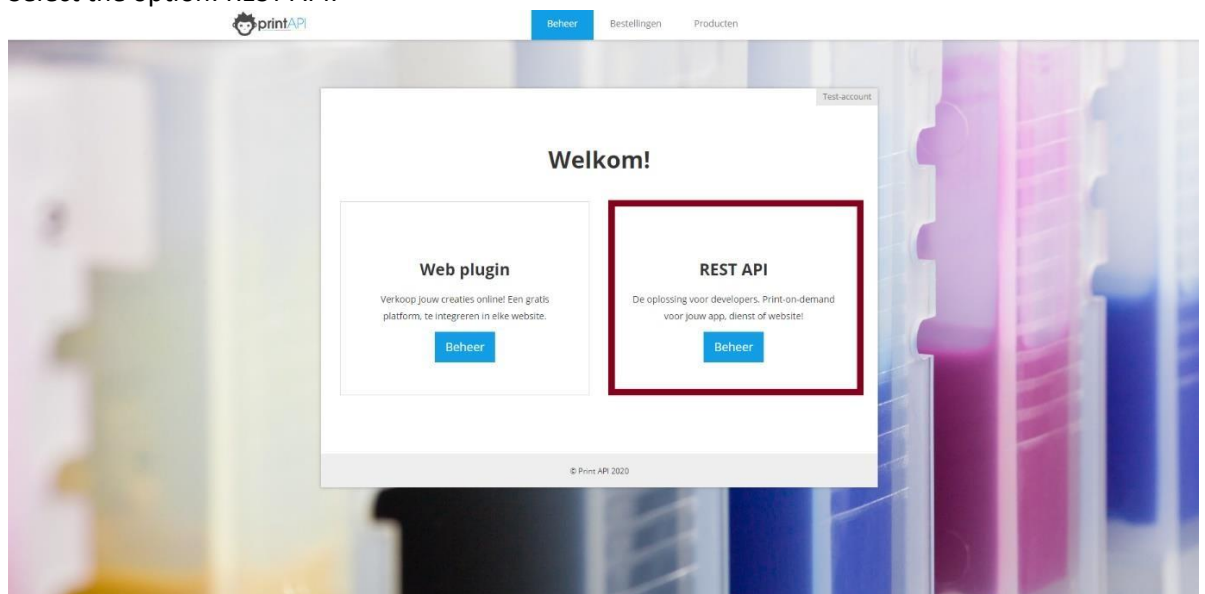

3. Copy the Print API client ID and Print API secret.

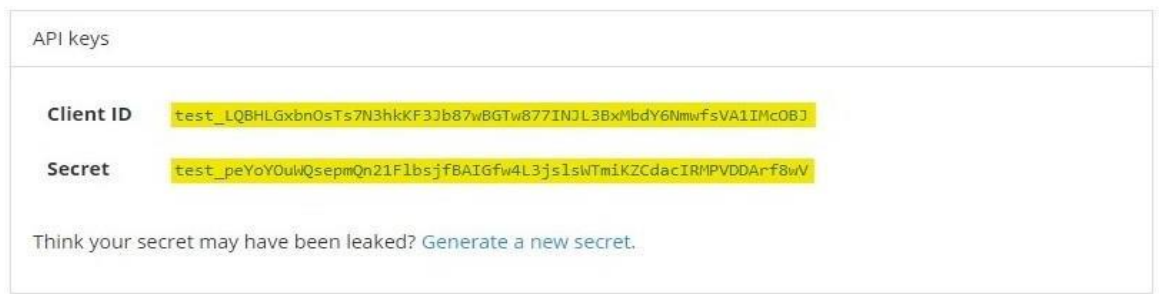

4. In your WordPress account, select WooCommerce and go to 'Settings'.

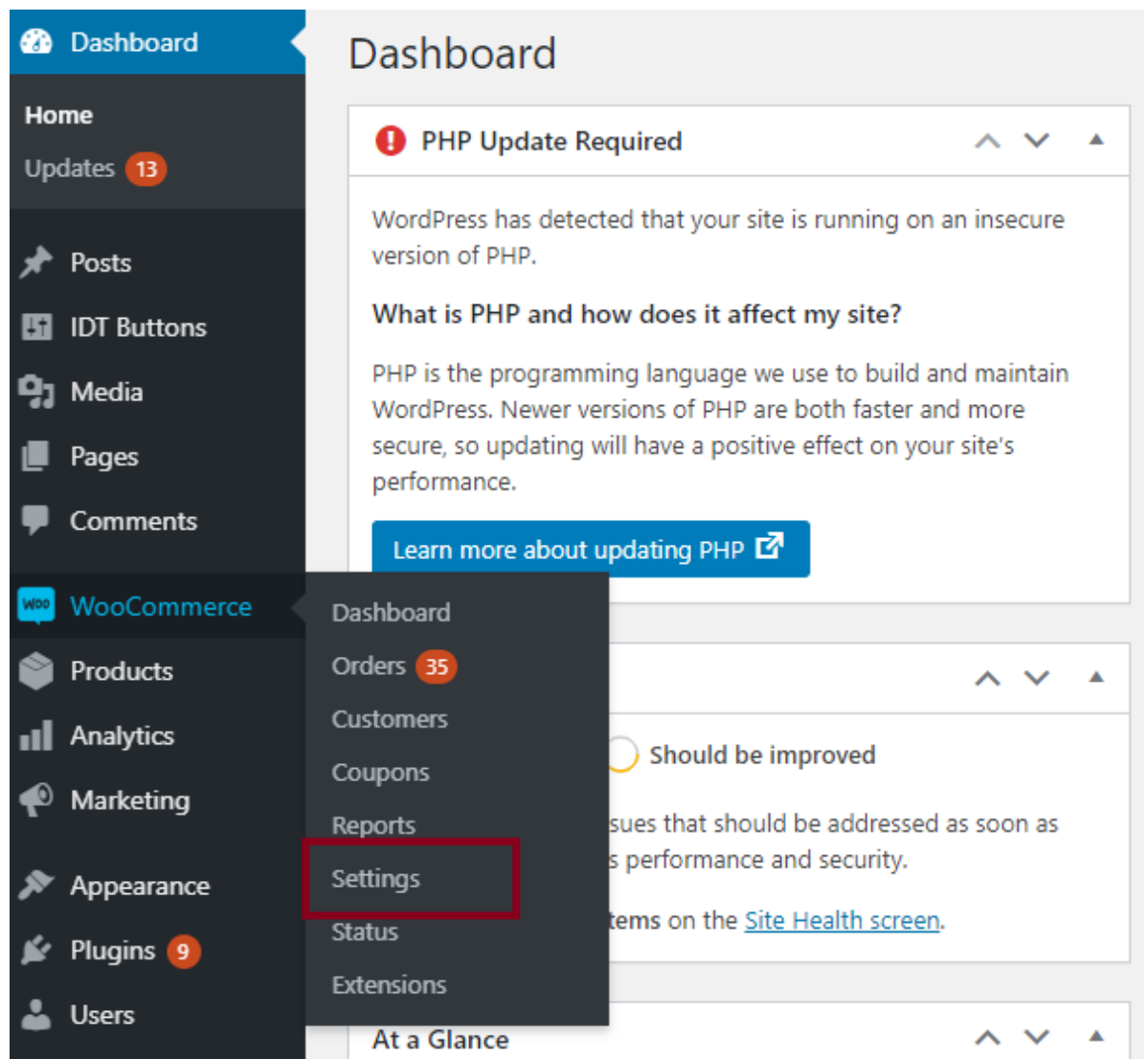

5. Select IDT Settings in the option menu.

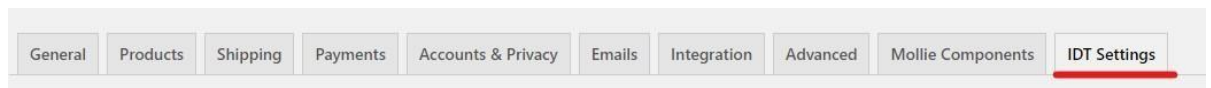

6. Scroll down and copy-paste the Print API client ID and Print API secret into the respective fields.

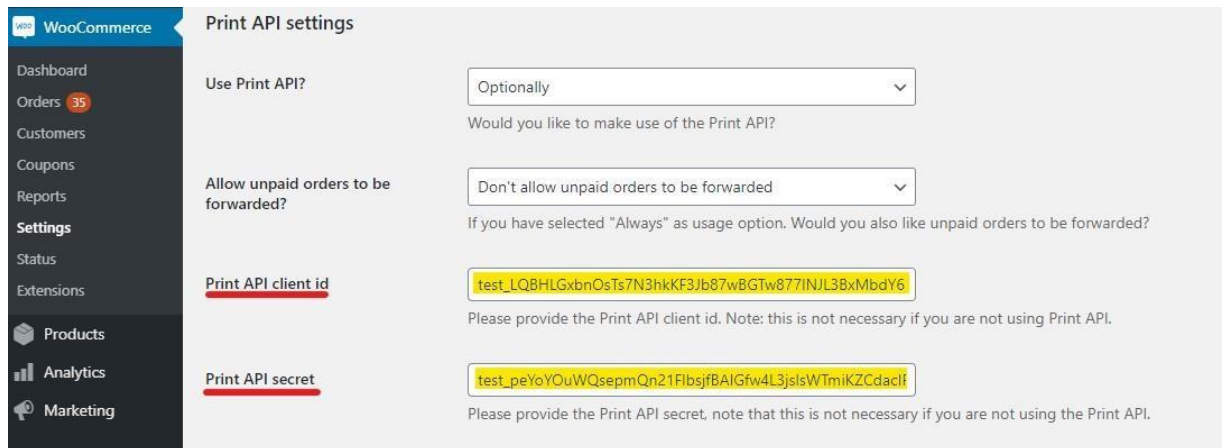

7. Under "Use Print API?" select the option that fits your needs.

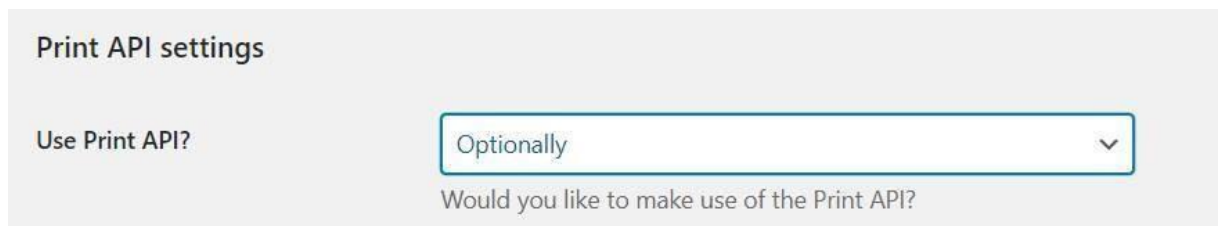

8. Under the option "Print API environment" choose 'Test'.



\* Test keys are for testing only. Once you are done with testing and are ready to go live you should request a live account at Print API. Open this live account and copy the live keys and repeat step 6. After that, change the Print API environment in step 8 to 'Live'. Now you are ready to start selling your product.

**You have now successfully integrated your WooCommerce plugin with Print API, well done!**